

DESCRIPTION	REVISION							
	DATE	COR.	CHK.	APP.	APP.	APP.	APP.	APP.

REG	STATE	PROJECT	SHEET NO.	TOTAL SHEETS
3	D.C.		1	1

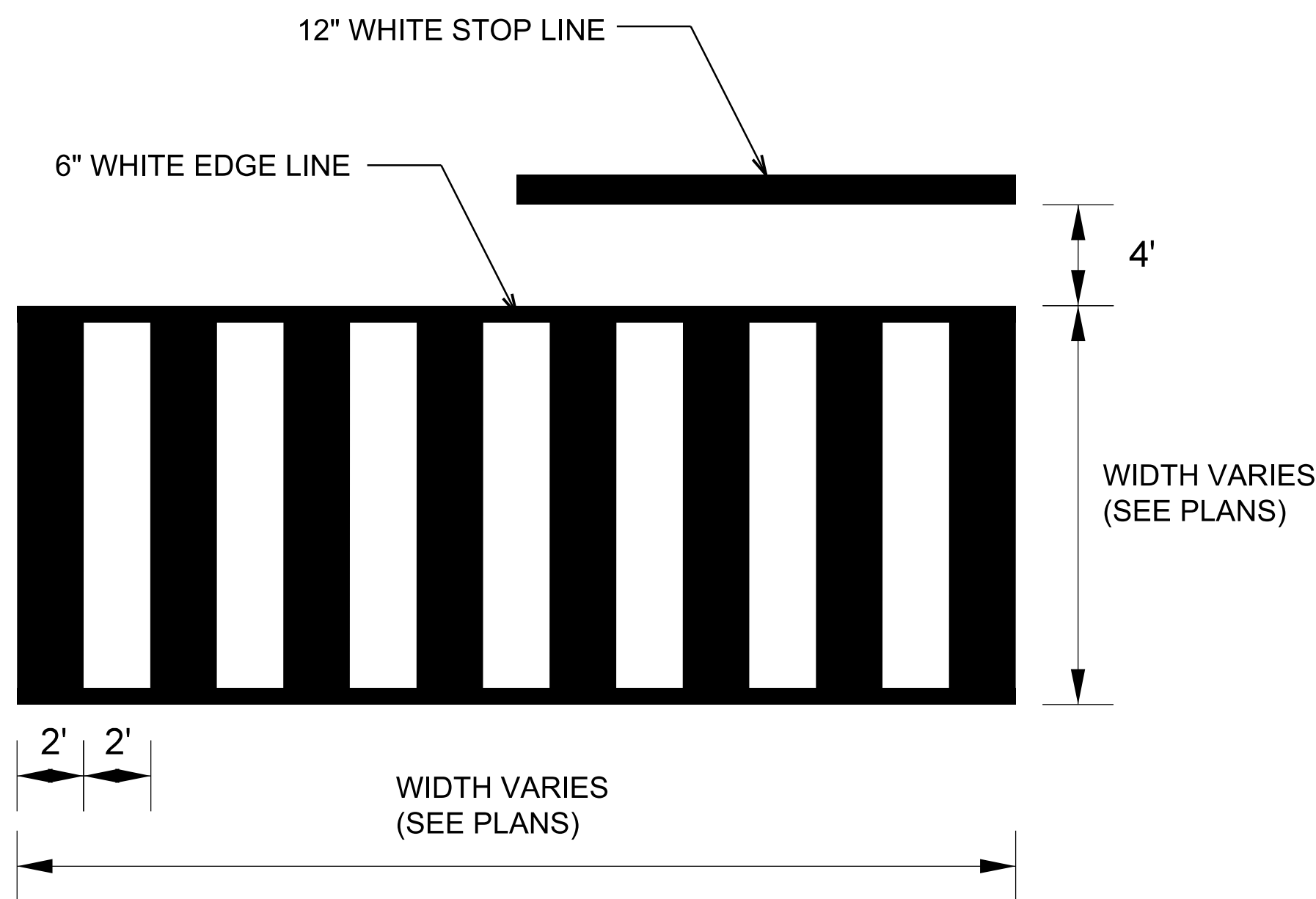

STOP PAVEMENT MARKING DETAIL
N.T.S.



CROSSWALK DETAIL
N.T.S.



- NOTES:**
 1. INSTALLATION TO BE COMPLETED IN ACCORDANCE WITH MANUFACTURER'S SPECIFICATIONS.
 2. DIMENSIONS, MATERIALS, AND ATTACHMENTS MAY VARY BETWEEN MANUFACTURERS.

REFLECTIVE PAVEMENT MARKER DETAIL
N.T.S.



NO PARKING PAVEMENT MARKING DETAIL
N.T.S.

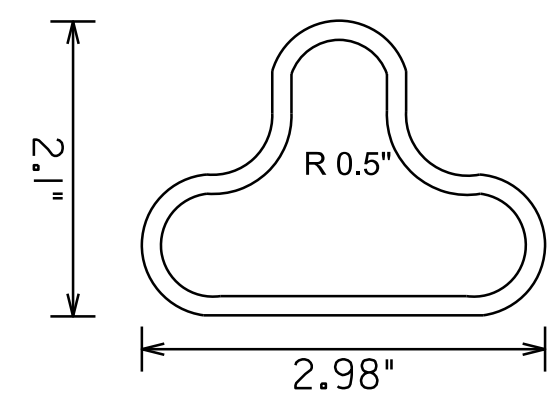

SECTION A-A

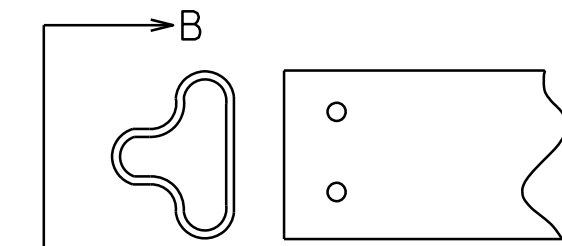

SECTION B-B
HOLES FOR BASE MOUNT



POST IS RETAINED TO BASE WITH 2 PINS

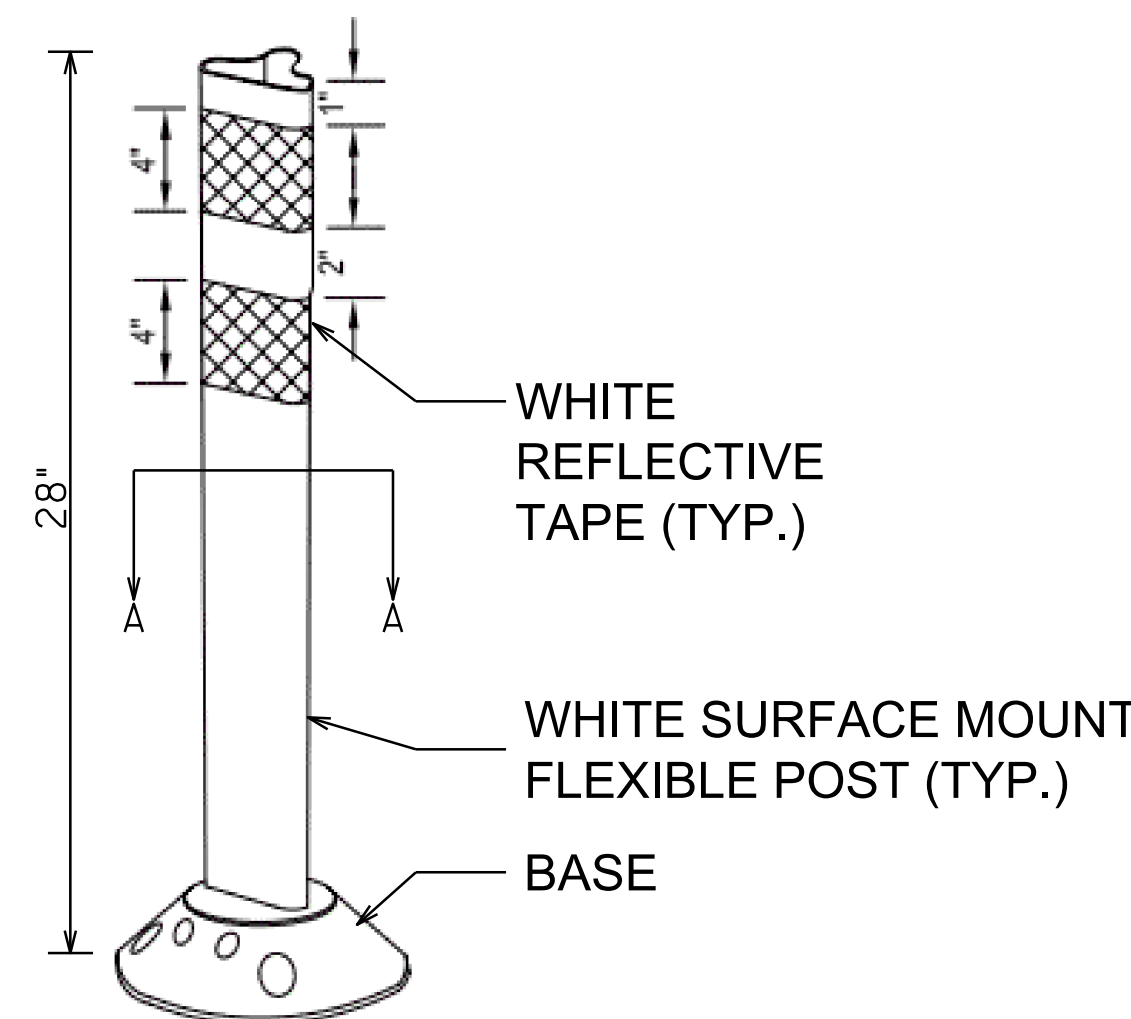

SHOWN WITH TYPICAL REFLECTIVE TAPE APPLIED

SURFACE MOUNT FLEXIBLE DELINEATOR POST DETAIL
N.T.S.

- NOTES:**
 1. INSTALLATION TO BE COMPLETED IN ACCORDANCE WITH MANUFACTURER'S SPECIFICATIONS.
 2. DIMENSIONS, MATERIALS, AND ATTACHMENTS MAY VARY BETWEEN MANUFACTURERS.
 3. COLOR OF POST SHALL MATCH COLOR OF APPLICABLE EDGE LINE.

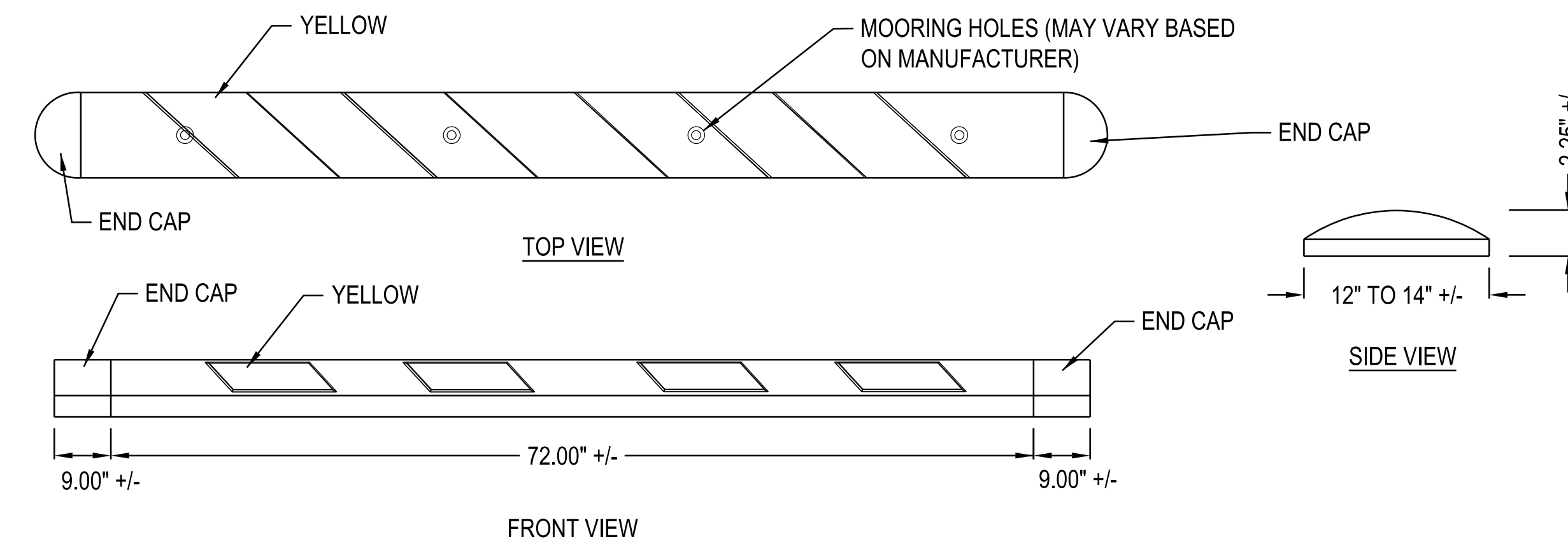

PREMIUM RUBBER SPEED BUMP SYSTEM
N.T.S.

- NOTES:**
 1. INSTALLATION TO BE COMPLETED IN ACCORDANCE WITH MANUFACTURER'S SPECIFICATIONS.
 2. DIMENSIONS, MATERIALS, AND ATTACHMENTS MAY VARY BETWEEN MANUFACTURERS.
 3. THE PER EACH QUANTITY WILL BE FOR EACH MAIN SEGMENT OF LENGTH (72" +/-). END CAPS SHALL BE ADDED ON THE TRAILING AND APPROACH ENDS PROVIDED SPACE IS AVAILABLE.

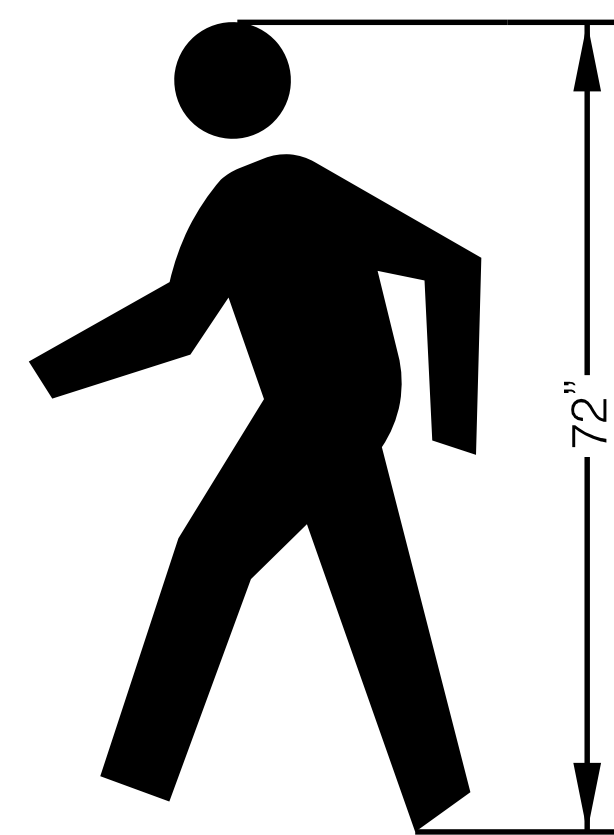

WALKING FACILITY SYMBOL
N.T.S.



S.L.F. NO. _____
 APPROVED BY _____ DATE _____

DISTRICT OF COLUMBIA DEPARTMENT OF TRANSPORTATION TRAFFIC ENGINEERING AND SAFETY DIVISION		SN-DT
PRATHER'S ALLEY SAFETY IMPROVEMENTS		FIELD CHECKED BY MECGIF
DESIGNED BY GIF/MGB		DRAWN BY GIF/MGB
REVIEWED BY MWS		DATE 07 /21 /2022
SUBMITTED BY TRAFFIC SIGNAL ENGINEER	DATE	SCALE
RECOMMENDED TRAFFIC SIGNAL PROJECT MANAGER	DATE	SHEET 1 OF 1
ITS/TRAFFIC SIGNAL MAINTENANCE BRANCH MANAGER	DATE	DRAWING NO.
APPROVED ASSOCIATE DIRECTOR, TRAFFIC ENG. & SAFETY DIVISION	DATE	

REG.	STATE	PROJECT	SHEET NO.	TOTAL SHEETS
3	D.C.		1	1

DESCRIPTION	REVISION						
	DATE	COR.	CHK.	APP.	APP.	APP.	APP.

GENERAL NOTES:

- A. ALL SIGNS SHALL BE INSTALLED IN ACCORDANCE WITH PART 2 OF THE 2009 MUTCD AND ALL RELEVANT DDOT STANDARDS. ALL PRIMARY SIGNS SHALL BE INSTALLED A MINIMUM OF 7' ABOVE THE SIDEWALK SURFACE.
- B. THE CONTRACTOR SHALL CONTACT MISS UTILITY TO LOCATE ALL UNDERGROUND UTILITIES BEFORE EXCAVATING FOR INSTALLATION OF ANY TRAFFIC SIGN POSTS.
- C. ALL EXISTING PAVEMENT MARKINGS MAY NOT BE SHOWN. ALL EXISTING PAVEMENT MARKINGS THAT CONFLICT WITH PROPOSED PAVEMENT MARKINGS SHALL BE ERADICATED BY A METHOD APPROVED BY DDOT.
- D. NO ABOVE GROUND HARDWARE OR EQUIPMENT SHALL BE INSTALLED SUCH THAT A 4 FOOT CLEAR PATH IS NOT AVAILABLE FOR ADA PURPOSES.

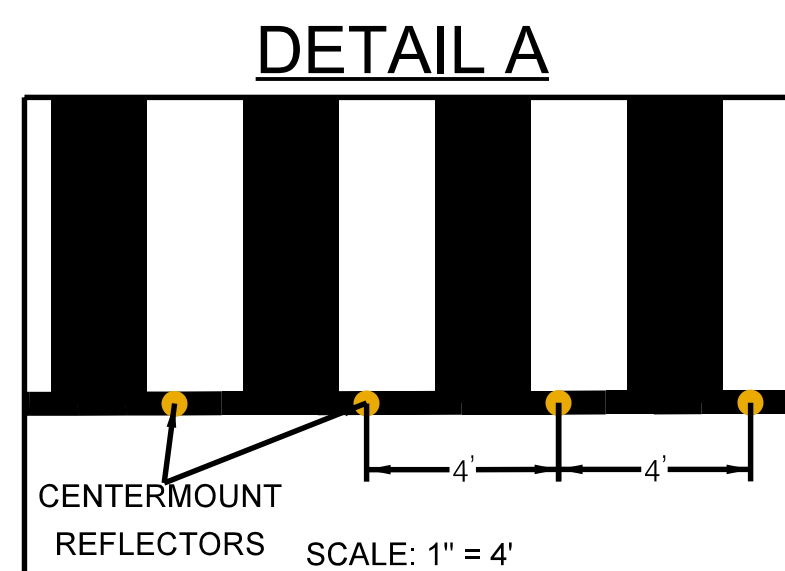
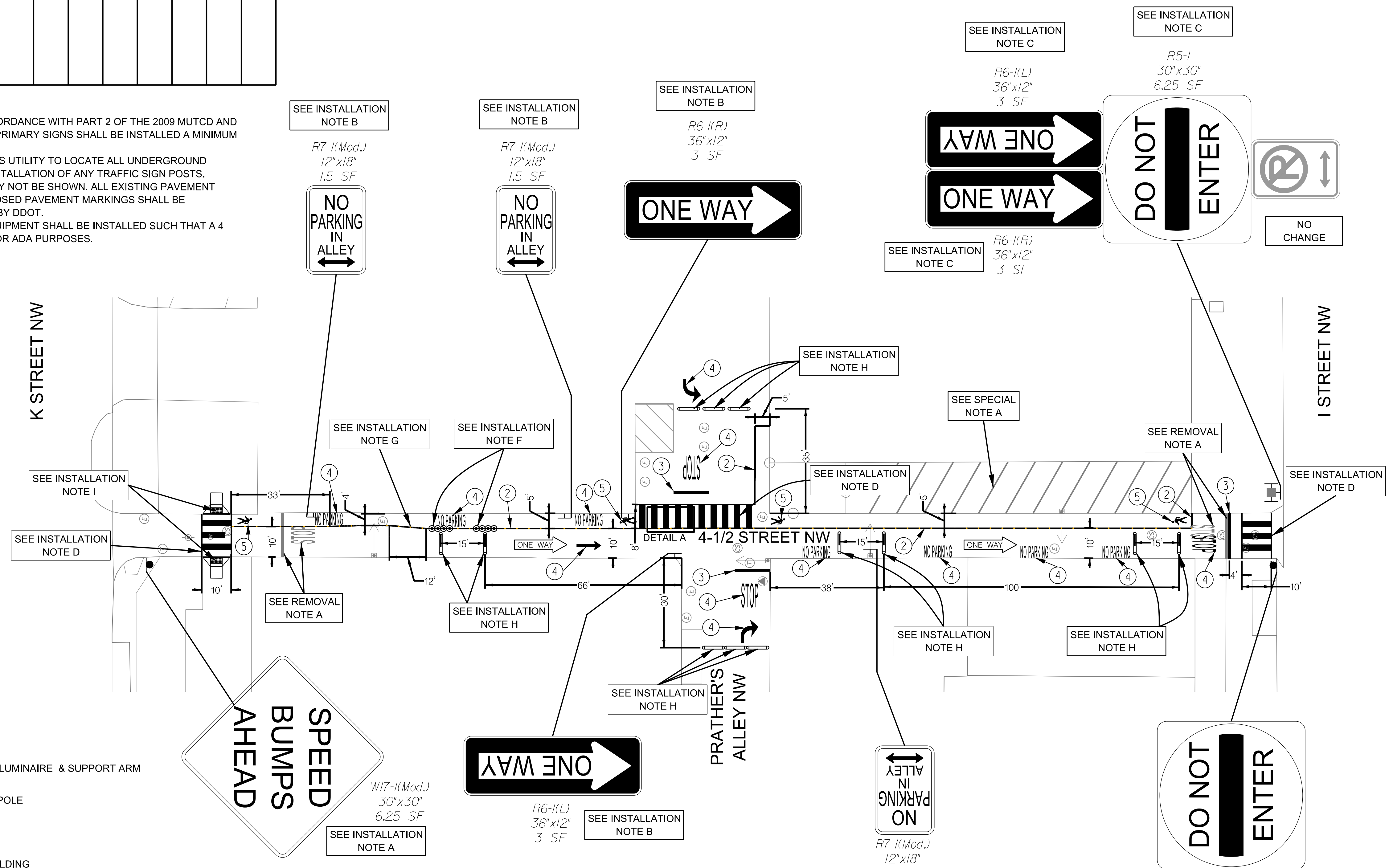

LEGEND:

- EXISTING SIGN TO REMAIN
- PROPOSED SIGN
- EXISTING PENDANT POLE WITH LUMINAIRE & SUPPORT ARM
- EXISTING NO. 16 STREETLIGHT POLE
- PROPOSED SIGN POST
- SIGN ON EXISTING POLE OR BUILDING
- PROPOSED SPEED BUMP
- PROPOSED FLEX POST
- PROPOSED CENTERMOUNT REFLECTOR

PAVEMENT MARKING INSTALLATION LEGEND

- ① 4" SOLID WHITE LANE LINE
- ② 6" SOLID WHITE LANE LINE
- ③ 12" WHITE STOP LINE
- ④ WHITE PAVEMENT ARROW AND TEXT
- ⑤ WHITE PEDESTRIAN SYMBOL PAVEMENT MARKING

SPECIAL NOTES:

- A. PARKING SPACES TO BE REALIGNED BY PROPERTY OWNER.

INSTALLATION NOTES:

- A. INSTALL PROPOSED SIGN ON PROPOSED SIGN POST.
- B. INSTALL PROPOSED SIGN ON SIDE OF BUILDING. CONTRACTOR TO COORDINATE WITH MVT CID.
- C. INSTALL PROPOSED SIGN ON EXISTING LIGHT POLE.
- D. INSTALL WHITE THERMOPLASTIC HIGH-VISIBILITY CROSSWALK PAVEMENT MARKINGS, 6" BORDER WIDTH WITH 24" HATCH LINES AT 24" SPACING. SEE PLAN FOR CROSSWALK WIDTH.
- E. INSTALL DIAGONAL HATCHING WITH A 4" SOLID WHITE PAINT EDGE LINE AND 4" SOLID WHITE PAINT DIAGONAL LINES AT A 45 DEGREE ANGLE, SPACE 5' O.C.
- F. INSTALL FLEXIBLE DELINEATOR POSTS ALONG 6" SOLID WHITE EDGE LINE, 2' O.C. SEE SHEET SN-DT FOR DELINEATOR POST DETAIL.
- G. INSTALL REFLECTIVE PAVEMENT MARKERS ALONG 6" SOLID WHITE EDGE LINE, 4' O.C. SEE SHEET SN-DT FOR DETAIL.
- H. INSTALL PREFORMED RUBBER SPEED BUMP. SEE SHEET SN-DT FOR SPEED BUMP DETAIL.
- I. INSTALL ADA COMPLIANT PEDESTRIAN CURB RAMP PER DDOT STD. DWG. NO. 606.08.

REMOVAL NOTE:

- A. REMOVE EXISTING PAVEMENT MARKINGS

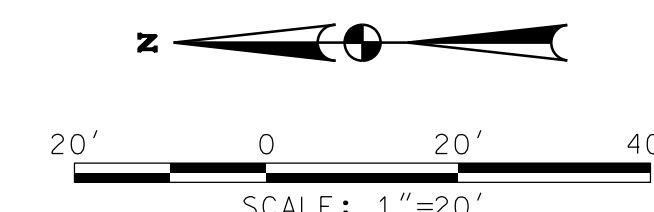

S.L.F. NO. _____
 APPROVED BY _____ DATE _____

DISTRICT OF COLUMBIA DEPARTMENT OF TRANSPORTATION TRAFFIC ENGINEERING AND SAFETY DIVISION		FIELD CHECKED BY MECGIF
PRATHER'S ALLEY SAFETY IMPROVEMENTS SIGNING AND PAVEMENT MARKING PLAN		DESIGNED BY MGB/GIF
		DRAWN BY MGB/GIF
		REVIEWED BY MWS
SUBMITTED BY TRAFFIC SIGNAL ENGINEER	DATE	DATE 07/21/2022
RECOMMENDED TRAFFIC SIGNAL PROJECT MANAGER	DATE	SCALE 1" = 20'
ITS-TRAFFIC SIGNAL MAINTENANCE BRANCH MANAGER	DATE	SHEET 1 OF 1
APPROVED ASSOCIATE DIRECTOR, TRAFFIC ENG. & SAFETY DIVISION	DATE	DRAWING NO.

Thursday, July 21, 2022, AT 11:30 AM
 c:\pwworking\jmt\mws\mjt.com\d0479241\pSN-F001_Pr-Other's-Alley.dgn